

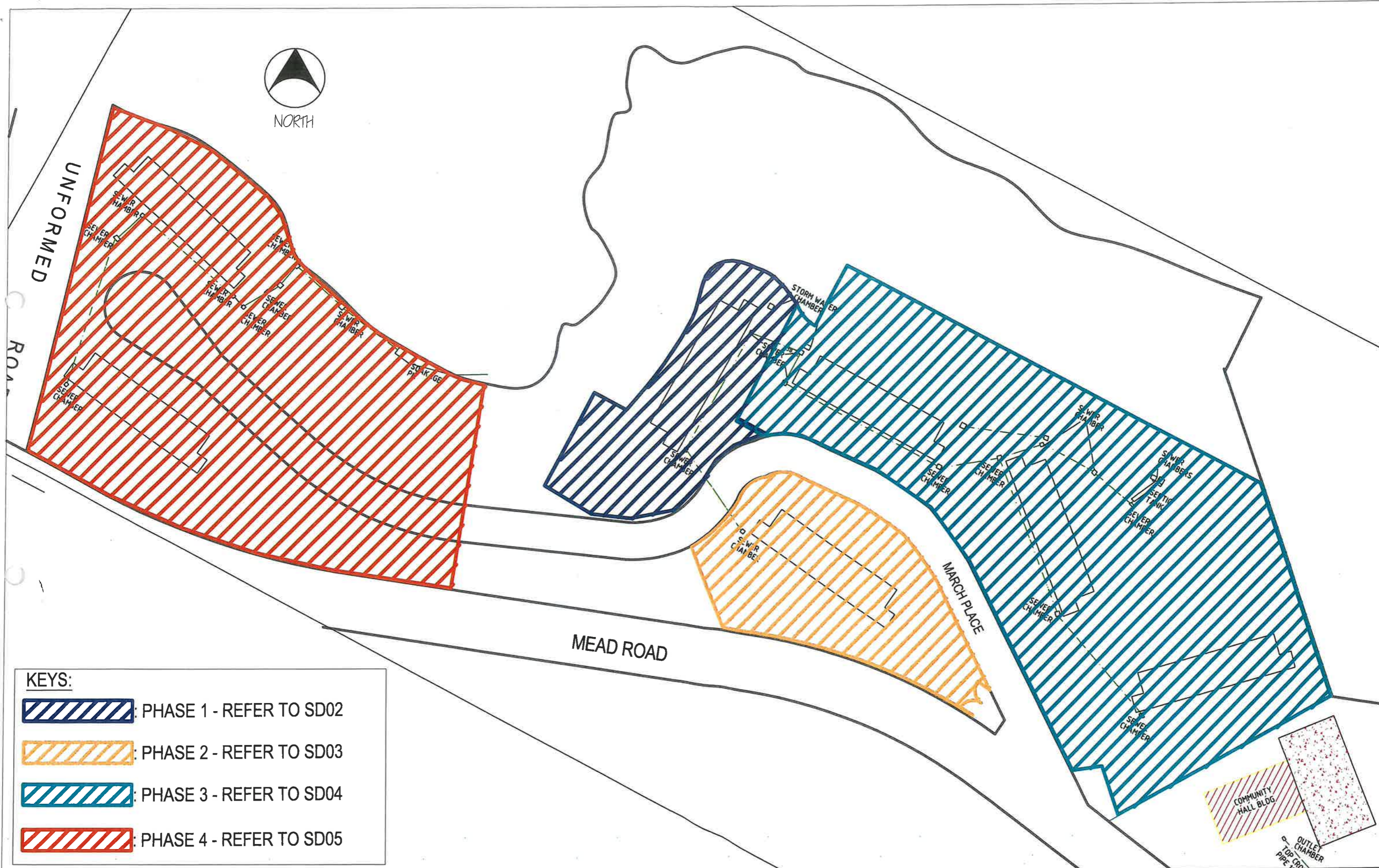



file copy



**KEYS:**

-  PHASE 1 - REFER TO SD02
-  PHASE 2 - REFER TO SD03
-  PHASE 3 - REFER TO SD04
-  PHASE 4 - REFER TO SD05

	SUVA 132 GRANTHAM RD RAIWAI PHONE 3387787 FAX 3370105 EMAIL info@prb.com www.wix.com/prbfj/prbwebsite	LAUTOKA 12 HECTOR ST NATOKOWAGA PHONE 6688717 FAX 6666970	LABASA 7 TUATUA ST LABASA PHONE 8816717 FAX 8814233	THE CONTRACTOR SHALL VERIFY ALL DIMENSIONS ON SITE AND BE RESPONSIBLE FOR REPORTING ANY DISCREPANCIES TO PUBLIC RENTAL BOARD BEFORE COMMENCING ANY WORKS. THESE DRAWINGS ARE THE COPYRIGHT PROPERTY OF THE PUBLIC RENTAL BOARD AND MUST BE RETURNED ON COMPLETION OF THE WORK. DO NOT SCALE PRINTS.	PROJECT TITLE : <b>PROPOSED MASTER DEMOLITION SITE PLAN - FOR PUBLIC RENTAL BOARD AT MEAD ROAD ESTATE.</b>	DRAWING TITLE : <b>MASTER DEMOLITION SITE PLAN</b>	DESIGN : LV/MD DRAWN : LV CHECKED : MD	REVISION NOTES :	DATE : OCT 2025 SCALE : 1:750	SHT NO : <b>SD01</b>
--	---	---	---	---	---	---	--	------------------	----------------------------------	-------------------------

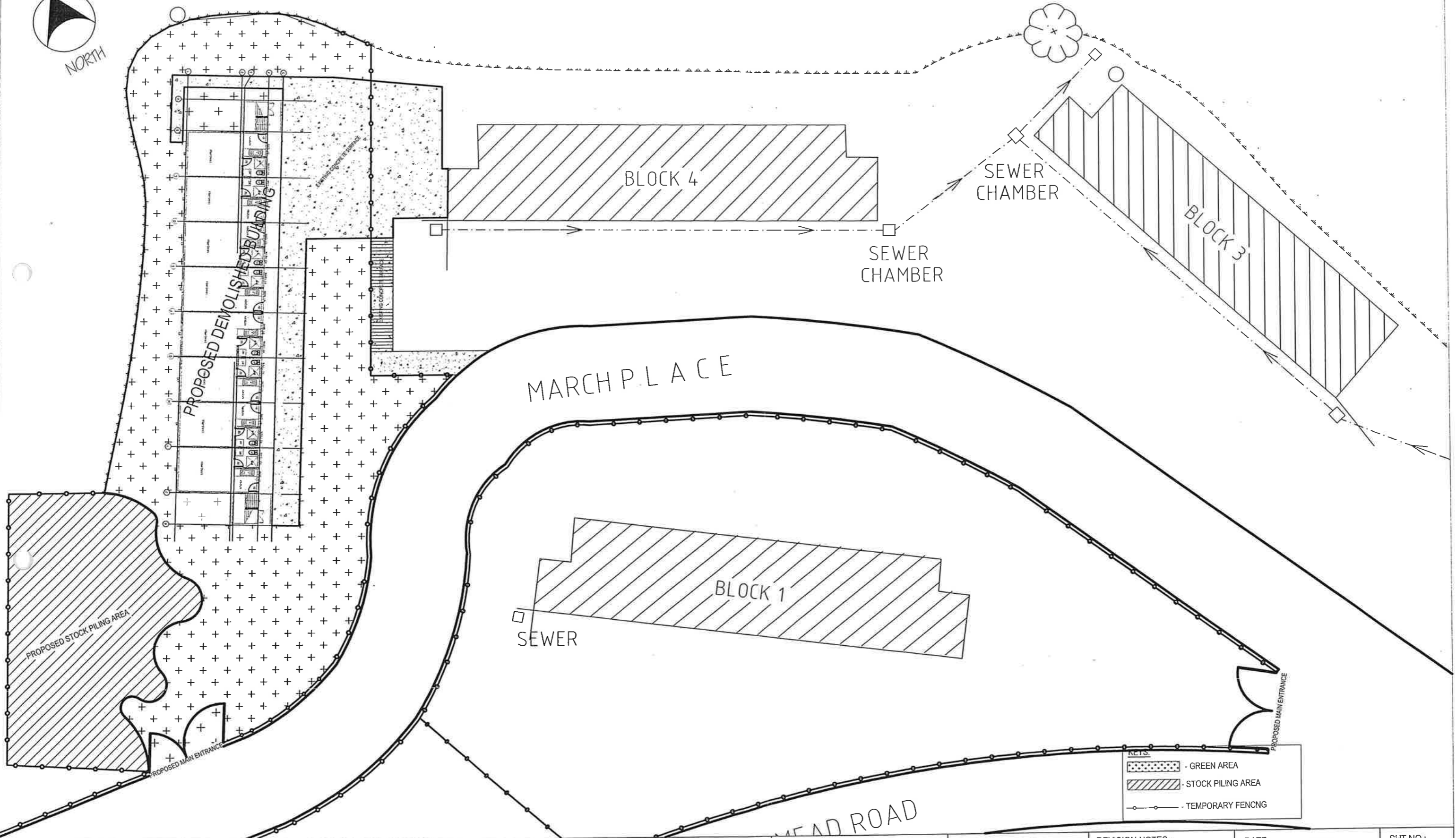

**PRB**  
My Home

SUVA  
132 GRANTHAM RD  
RAIWA  
PHONE 3387787  
FAX 3370105  
EMAIL: info@prb.com.fj  
www.wic.com/prb/fj/prbwebsite

LAUTOKA  
12 HECTOR ST  
NATOKOWAGA  
PHONE 8868717  
FAX 6669570

LABASA  
7 TUATUA ST  
LABASA  
PHONE 8814233

THE CONTRACTOR SHALL VERIFY ALL DIMENSIONS ON SITE AND BE RESPONSIBLE FOR REPORTING ANY DISCREPANCIES TO PUBLIC RENTAL BOARD® BEFORE COMMENCING ANY WORKS. THESE DRAWINGS ARE THE COPYRIGHT PROPERTY OF THE PUBLIC RENTAL BOARD® AND MUST BE RETURNED ON COMPLETION OF THE WORK. DO NOT SCALE PRINTS.

PROJECT TITLE :  
**PROPOSED DEMOLITION SITE PLAN - PHASE 1 FOR PUBLIC RENTAL BOARD AT MEAD ROAD ESTATE.**

DRAWING TITLE :  
**DEMOLITION SITE PLAN**

DESIGN : LV/MD  
DRAWN : LV  
CHECKED : MD

REVISION NOTES :

DATE : OCT 2025  
SCALE : 1:300

SHT NO :  
**SD02**

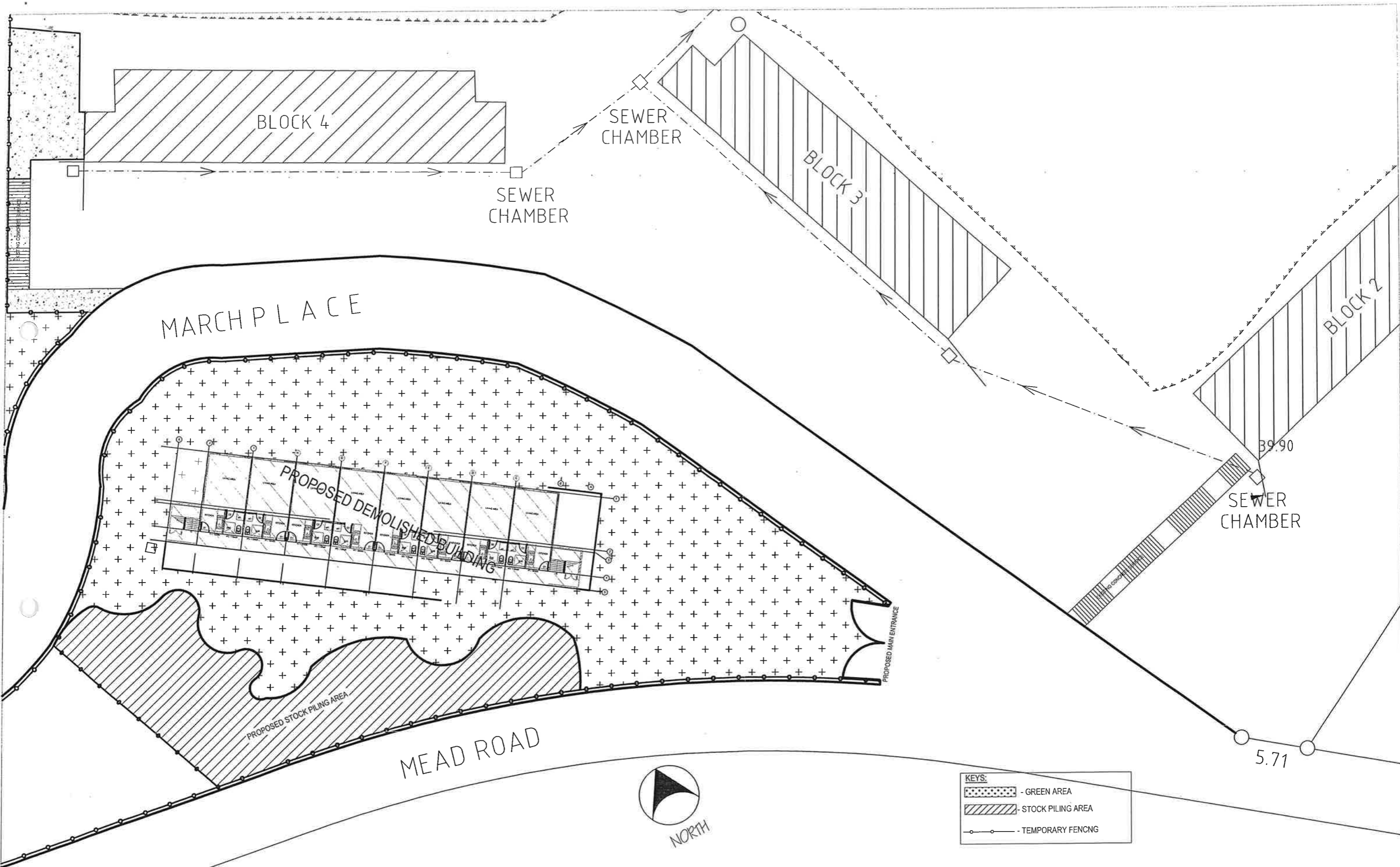

	SUVA 132 GRANTHAM RD RAIWAI PHONE 3387787 FAX 3370105 EMAIL: info@prb.com.fj www.wix.com/prb/fj/prbweb20	LAUTOKA 12 HECTOR ST NATOKOWAGA PHONE 6668717 FAX 6666970	LABASA 7 TUATUA ST LABASA PHONE 6616717 FAX 8814233	THE CONTRACTOR SHALL VERIFY ALL DIMENSIONS ON SITE AND BE RESPONSIBLE FOR REPORTING ANY DISCREPANCIES TO PUBLIC RENTAL BOARD BEFORE COMMENCING ANY WORKS. THESE DRAWINGS ARE THE COPYRIGHT PROPERTY OF THE PUBLIC RENTAL BOARD AND MUST BE RETURNED ON COMPLETION OF THE WORK. DO NOT SCALE PRINTS.	PROJECT TITLE: <b>PROPOSED DEMOLITION SITE PLAN - PHASE 2 FOR PUBLIC RENTAL BOARD AT MEAD ROAD ESTATE.</b>	DRAWING TITLE: <b>DEMOLITION SITE PLAN</b>	DESIGN: LV/MD DRAWN: LV CHECKED: MD	REVISION NOTES:	DATE: OCT 2025 SCALE: 1:300	SHT NO: <b>SD03</b>
--	--	---	---	---	---	---	---	-----------------	--------------------------------	------------------------

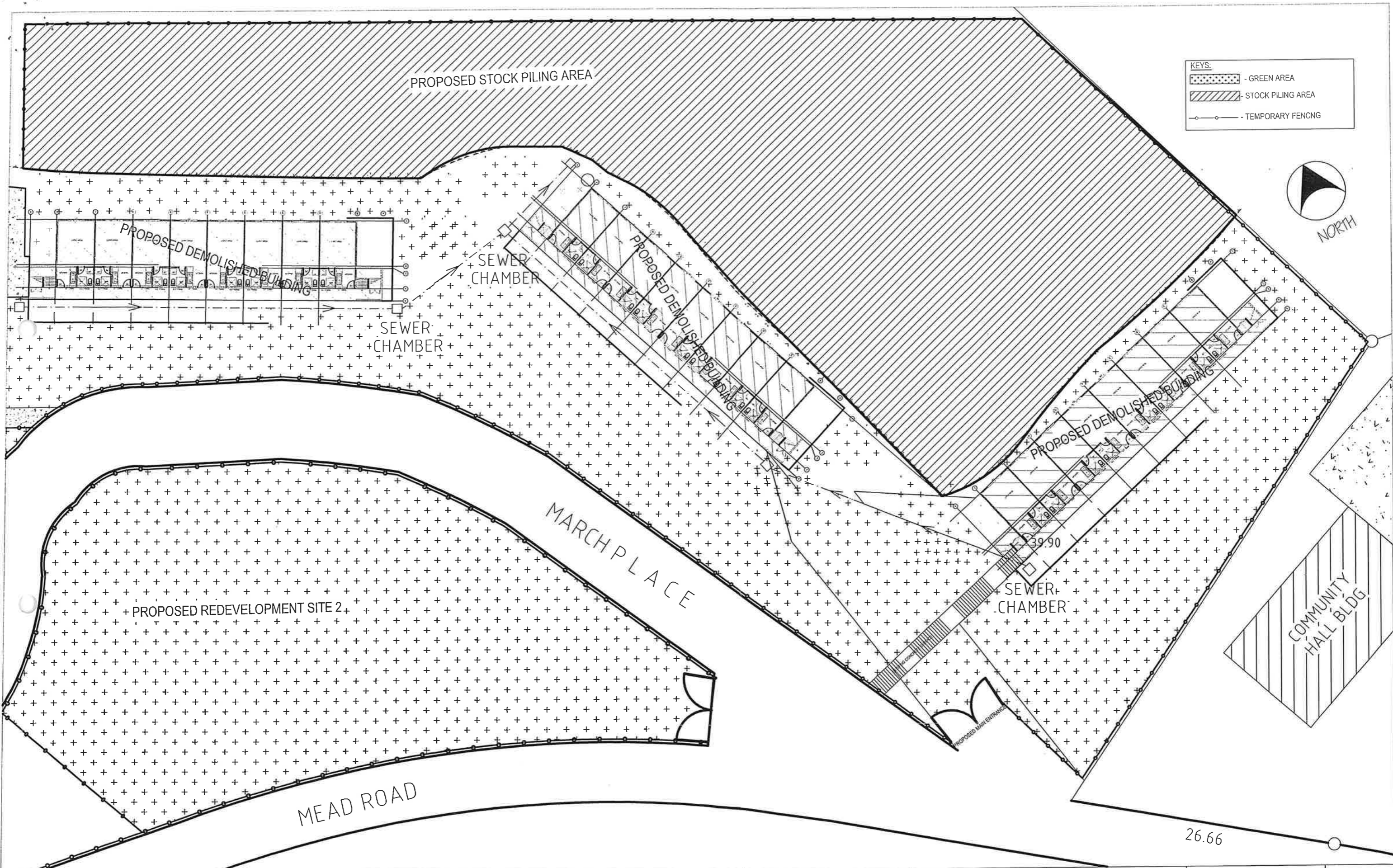

KEYS:

	- GREEN AREA
	- STOCK PILING AREA
	- TEMPORARY FENCNG

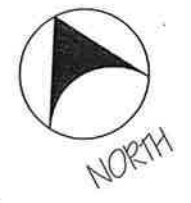

	SUVA 132 GRANTHAM RD RAIWAI PHONE 3387787 FAX 3370105 EMAIL - info@prb.com.fj www.wir.com/prb/fj/prbwebsite	LAUTOKA 12 HECTOR ST NATOKOWAQA PHONE 6668717 FAX 6660970	LABASA 7 TUATUA ST LABASA PHONE #816717 FAX 8814233	THE CONTRACTOR SHALL VERIFY ALL DIMENSIONS ON SITE AND BE RESPONSIBLE FOR REPORTING ANY DISCREPANCIES TO PUBLIC RENTAL BOARD BEFORE COMMENCING ANY WORKS. THESE DRAWINGS ARE THE COPYRIGHT PROPERTY OF THE PUBLIC RENTAL BOARD AND MUST BE RETURNED ON COMPLETION OF THE WORK. DO NOT SCALE PRINTS.	PROJECT TITLE : <b>PROPOSED DEMOLITION SITE PLAN - PHASE 3 FOR PUBLIC RENTAL BOARD AT MEAD ROAD ESTATE.</b>	DRAWING TITLE : <b>DEMOLITION SITE PLAN</b>	DESIGN : LV/MD DRAWN : LV CHECKED : MD	REVISION NOTES :	DATE : OCT 2025 SCALE : 1:350	SHT NO : <b>SD04</b>
--	---	---	---	---	--	--	--	------------------	----------------------------------	-------------------------

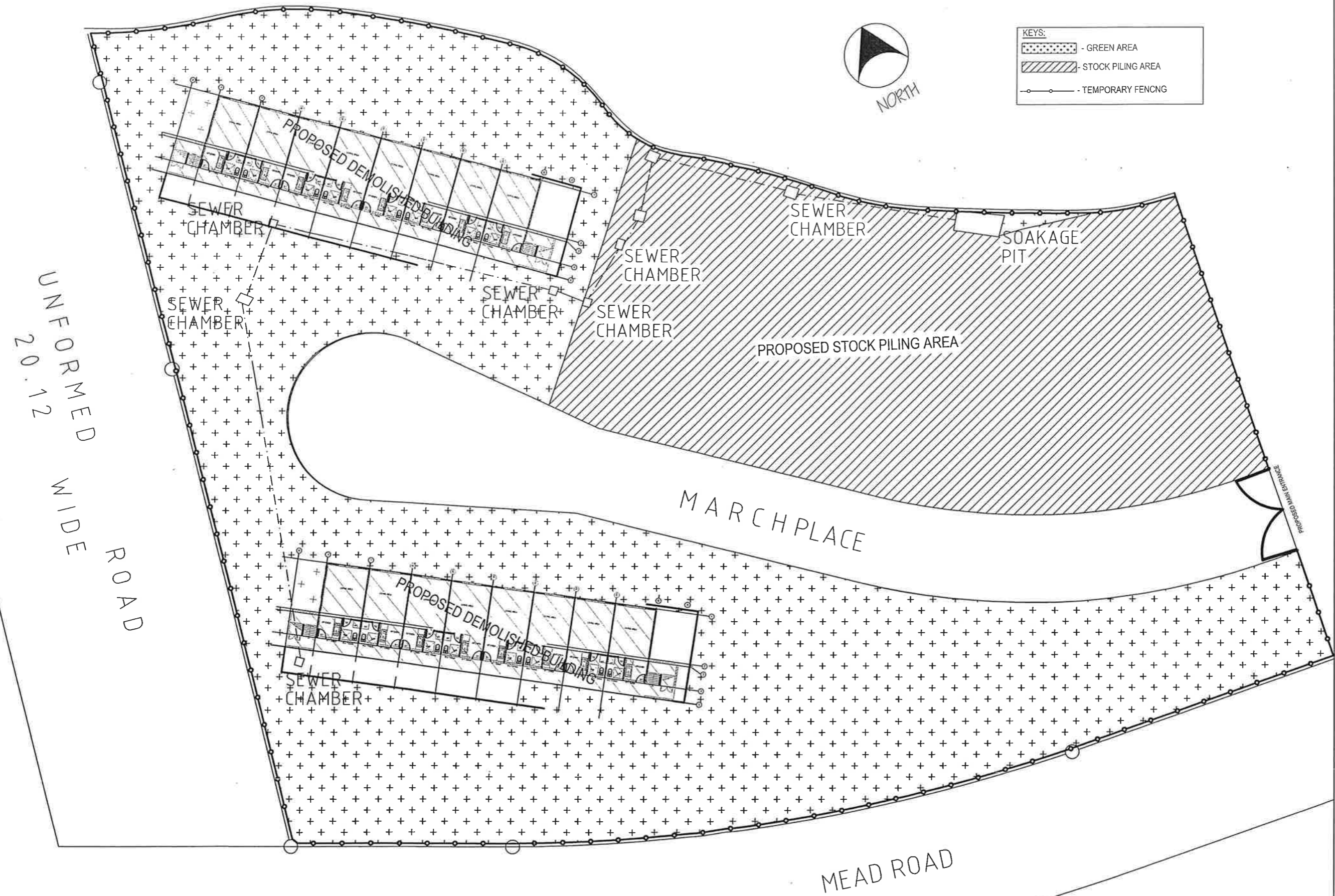

SUVA  
132 GRANTHAM RD  
RAIWA  
PHONE 3387787  
FAX 3370165  
EMAIL - info@prb.com.fj  
www.wkr.com/prb/fj/prbwebsite

LAUTOKA  
12 HECTOR ST  
NATOKOWAGA  
PHONE 6668717  
FAX 6669970

LABASA  
7 TUATUA ST  
LABASA  
PHONE 8816717  
FAX 8814233

THE CONTRACTOR SHALL VERIFY ALL DIMENSIONS ON SITE AND BE RESPONSIBLE FOR REPORTING ANY DISCREPANCIES TO PUBLIC RENTAL BOARD BEFORE COMMENCING ANY WORKS. THESE DRAWINGS ARE THE COPYRIGHT PROPERTY OF THE PUBLIC RENTAL BOARD AND MUST BE RETURNED ON COMPLETION OF THE WORK. DO NOT SCALE PRINTS.

PROJECT TITLE :  
PROPOSED DEMOLITION SITE PLAN - PHASE 4 FOR PUBLIC RENTAL BOARD AT MEAD ROAD ESTATE.

DRAWING TITLE :  
DEMOLITION SITE PLAN

DESIGN : LV/MD  
DRAWN : LV  
CHECKED : MD

REVISION NOTES :

DATE : OCT 2025  
SCALE : 1:350

SHT NO :  
SD05